

Section One

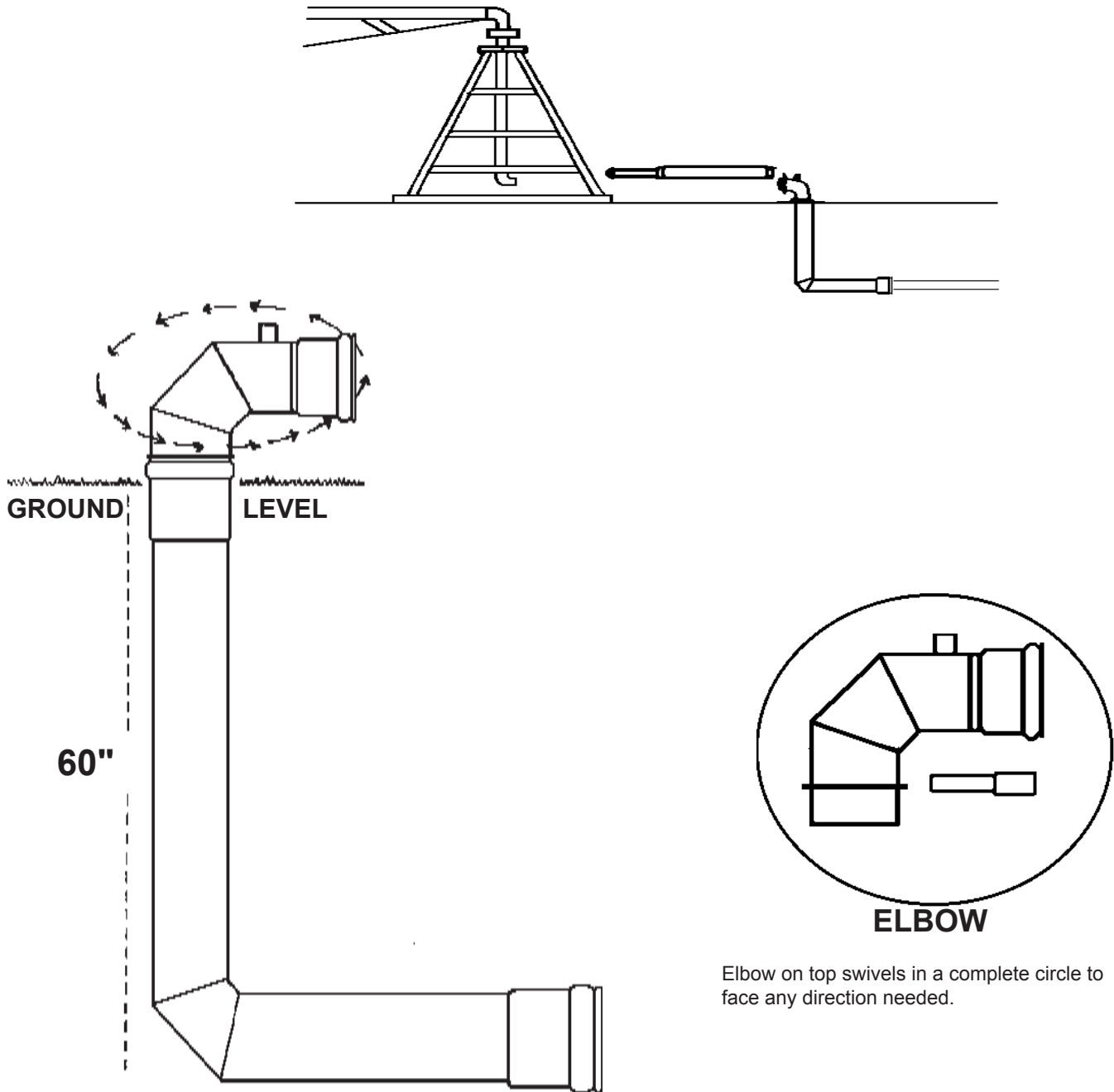

Powder Coated Steel Fittings
Galvanized Steel Fittings
PVC Fittings
Riser Valves
Clamp-on Saddles, Couplers,
Male Ends
Repair Couplers

PVC Accessories
Bolt-on Dresser Fittings
Solvent PVC Pipe Fittings
Gasketed PVC Pipe Fit-
tings
Drain Fittings



The above elbow is used along side the pivot pad. The elbow can be removed so that when the pivot is moved from one pad to another the "L" will be flush with the ground.

Elbow on top swivels in a complete circle to face any direction needed.

STEEL UNDERGROUND FITTINGS



Product	Description	Part Number	Weight	List Price
---------	-------------	-------------	--------	------------

Z PIPE (LONG BASE)

(POWDER COATED OR GALVANIZED)



Female RL Top:

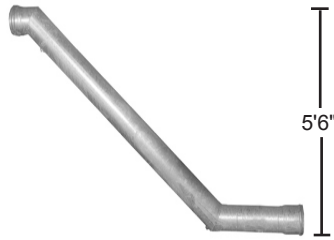

6" PIP	6-1961-L	71.0	335.00
8" PIP	6-1962-L	94.9	395.00
10" PIP	6-1963-L	120.3	529.00
12" PIP	6-1968-L	146.6	645.00
4" IPS	8-1416-L	45.7	332.52
6" IPS	6-1971-L	71.0	335.00
8" IPS	6-1972-L	94.9	395.00
10" IPS	6-1973-L	120.0	529.00
12" IPS	6-1969-L	146.6	645.00

Male RL Top:

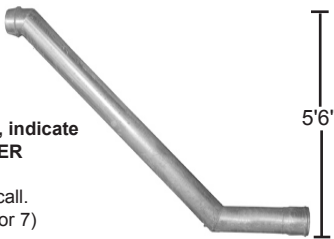

6" PIP	6-1964-L	73.3	335.00
8" PIP	6-1965-L	96.9	395.00
10" PIP	6-1966-L	122.5	529.00
12" PIP	6-1967-L	154.6	645.00
4" IPS	8-1417-L	48.4	332.52
6" IPS	6-1974-L	73.3	335.00
8" IPS	6-1975-L	96.9	395.00
10" IPS	6-1976-L	111.5	529.00
12" IPS	6-1977-L	154.6	645.00

Z Pipe: 15"x84"x36"

Female Bottom PIP/IPS.

Nipples & other acc. optional.

***IMPORTANT: When ordering, indicate either GALVANIZED or POWDER COATED finishes.**

* Metric sizes available, please call.

* 12 ga. tubing (optional 11, 10, or 7)

* For Shorter Base See p.5

L PIPE (LONG BASE)

(POWDER COATED OR GALVANIZED)

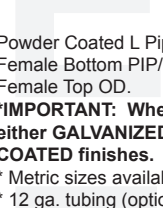

Powder Coated L Pipe: 60" x 40"

Female Bottom PIP/IPS

Female Top OD.

***IMPORTANT: When ordering, indicate either GALVANIZED or POWDER COATED finishes.**

* Metric sizes available, please call.

* 12 ga. tubing (optional 11, 10, or 7)

* For Shorter Base See p.5

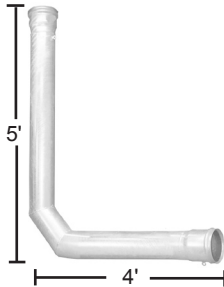

6" PIP	6-1981-L	54.7	310.00
8" PIP	6-1982-L	73.3	345.00
10" PIP	6-1983-L	92.8	445.00
12" PIP	6-1984-L	113.8	550.00
4" IPS	8-1418-L	34.9	305.00
6" IPS	6-1991-L	54.7	310.00
8" IPS	6-1992-L	73.3	345.00
10" IPS	6-1993-L	92.8	445.00
12" IPS	6-1994-L	113.8	550.00

J PIPE

(POWDER COATED OR GALVANIZED)

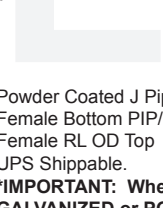

Powder Coated J Pipe: 48" x 24"

Female Bottom PIP/IPS

Female RL OD Top

UPS Shippable.

***IMPORTANT: When ordering, indicate either GALVANIZED or POWDER COATED finishes.**

* Metric sizes available, please call.

* 12 ga. tubing (optional 11, 10, or 7)

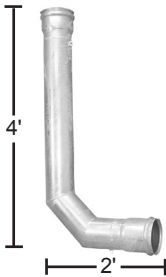

6" PIP	6-2000	36.0	275.00
8" PIP	6-2001	48.5	320.00
10" PIP	6-2002	61.7	395.00
12" PIP	6-2003	76.4	445.00
4" IPS	8-1419	22.5	249.00
6" IPS	6-2004	33.6	275.00
8" IPS	6-2005	48.5	320.00
10" IPS	6-2006	61.7	395.00
12" IPS	6-2007	76.4	445.00

T PIPE

(POWDER COATED OR GALVANIZED)

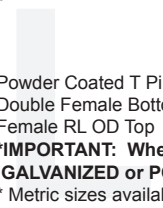

Powder Coated T Pipe: 60" x 24"

Double Female Bottom PIP/IPS

Female RL OD Top

***IMPORTANT: When ordering, indicate either GALVANIZED or POWDER COATED finishes.**

* Metric sizes available, please call.

* 12 ga. tubing (optional 11, 10, or 7)

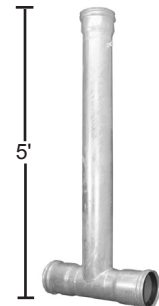

6" PIP	6-1986	42.0	300.00
8" PIP	6-1987	56.5	345.00
10" PIP	6-1988	72.7	440.00
12" PIP	6-1989	76.4	515.00
4" IPS	8-1420	25.5	229.00
6" IPS	6-1996	42.0	300.00
8" IPS	6-1997	56.5	345.00
10" IPS	6-1998	72.7	440.00
12" IPS	6-1990	89.4	515.00

Special fittings will be made to order, please call.

Powder coated fittings are fusion bonded with a Pratt & Lambert epoxy that is virtually indestructible.

Galvanized coating is also very durable and long-lasting.

STEEL UNDERGROUND FITTINGS

Underground Fittings

Product	Description	Part Number	Weight	List Price
---------	-------------	-------------	--------	------------

Z PIPE (SHORT BASE) (POWDER COATED OR GALVANIZED)

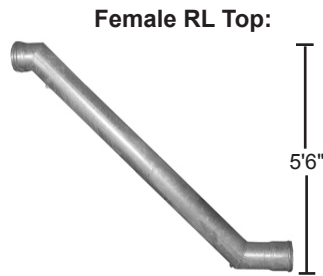

6" PIP	6-1961	59.8	335.00
8" PIP	6-1962	80.0	395.00
10" PIP	6-1963	101.3	510.00
12" PIP	6-1968	124.0	695.00
4" IPS	8-1416	38.3	289.00
6" IPS	6-1971	59.8	335.00
8" IPS	6-1972	80.0	395.00
10" IPS	6-1973	101.3	510.00
12" IPS	6-1969	124.0	695.00

Z Pipe: 15"x84"x15"
Female Bottom PIP/IPS.
Nipples & other acc. optional.
***IMPORTANT: When ordering, indicate either GALVANIZED or POWDER COATED finishes.**
* Metric sizes available, please call.
* 12 ga. tubing (optional 11, 10, or 7)
* For Longer Base add -L to part # See p.4

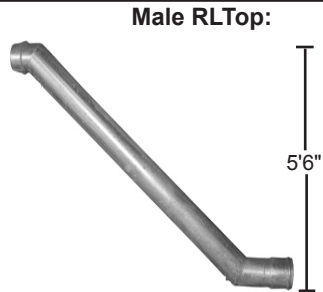

6" PIP	6-1964	61.4	335.00
8" PIP	6-1965	81.1	395.00
10" PIP	6-1966	102.8	510.00
12" PIP	6-1967	130.8	695.00
4" IPS	8-1417	38.3	289.00
6" IPS	6-1974	61.4	335.00
8" IPS	6-1975	81.1	395.00
10" IPS	6-1976	106.9	510.00
12" IPS	6-1977	130.8	695.00

L PIPE (SHORT BASE) (POWDER COATED OR GALVANIZED)

Powder Coated L Pipe: 60" x 24"
Female Bottom PIP/IPS
Female Top OD.
***IMPORTANT: When ordering, indicate either GALVANIZED or POWDER COATED finishes.**
* Metric sizes available, please call.
* 12 ga. tubing (optional 11,10, or 7)
* Longer Base add -L to part #. See p.4

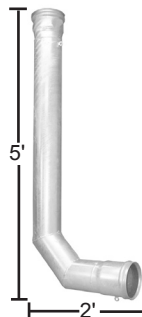

6" PIP	6-1981	41.1	300.00
8" PIP	6-1982	55.3	345.00
10" PIP	6-1983	70.2	445.00
12" PIP	6-1984	86.6	515.00
4" IPS	8-1418	25.9	259.00
6" IPS	6-1991	41.1	300.00
8" IPS	6-1992	55.3	345.00
10" IPS	6-1993	70.2	445.00
12" IPS	6-1994	86.6	515.00

RISER VALVE L (POWDER COATED OR GALVANIZED)



***IMPORTANT: When ordering, indicate either GALVANIZED or POWDER COATED finishes.**

6"x4" PIP xvalve	8-1410	67.6	355.00
6"x6" PIP xvalve	8-1324	69.6	375.00
8"x4" PIP xvalve	8-1412	92.1	419.00
8"x6" PIP xvalve	8-1414	104.2	439.00
8"x8" PIP xvalve	8-1326	99.5	510.00
6"x4" IPS xvalve	8-1411	67.6	355.00
6"x6" IPS xvalve	8-1325	69.6	375.00
8"x4" IPS xvalve	8-1413	92.1	419.00
8"x6" IPS xvalve	8-1415	104.2	439.00
8"x8" IPS xvalve	8-1327	99.5	510.00

RISER VALVE J (POWDER COATED OR GALVANIZED)



***IMPORTANT: When ordering, indicate either GALVANIZED or POWDER COATED finishes.**

6"x6" PIPxvalve	6-4001	39.0	339.00
8"x8" PIPxvalve	6-4002	59.0	479.00
6"x6" IPSxvalve	6-4005	39.0	339.00
8"x8" IPSxvalve	6-4006	59.0	479.00

WELD-ON & PVC FITTINGS



Product	Description	Part Number	Weight	List Price	
STEEL NIPPLE (WELDED ON)					
		2"	6-2960	0.5	15.00
		3"	6-2961	1.5	17.00
		4"	6-2962	2.7	22.00



Nipples welded on for air relief, surge plug, etc.

STEEL ARM (WELDED ON)	Male Thread	2"	6-2963	2.6	45.00
		3"	6-2934	5.5	97.00
		4"	6-2935	8.8	128.00
	Female Thread	2"	6-2936	2.5	45.00
		3"	6-2937	5.4	105.00
		4"	6-2938	8.0	135.00



Z PIPE (PVC)

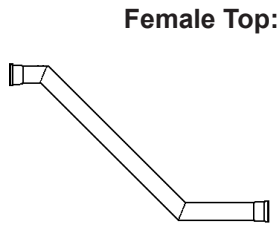

Female Top:

6" PIP	6-2700	21.5	295.00
8" PIP	6-2701	32.9	385.00
10" PIP	6-2702	48.1	495.00
12" PIP	6-2703	81.3	679.00
6" IPS	6-2704	24.9	349.00
8" IPS	6-2705	38.0	459.00
10" IPS	6-2706	57.2	615.00
12" IPS	6-2707	86.8	829.00

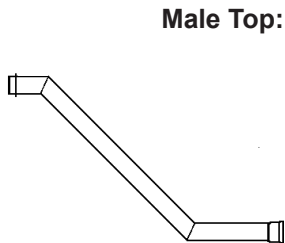

Male Top:

6" PIP	6-2708	21.5	295.00
8" PIP	6-2709	31.9	385.00
10" PIP	6-2710	48.6	495.00
12" PIP	6-2711	78.3	679.00
6" IPS	6-2712	24.9	349.00
8" IPS	6-2713	37.0	459.00
10" IPS	6-2714	57.7	615.00
12" IPS	6-2715	85.8	829.00

Z Pipe: 16"x84"x36"
Female Bottom PIP/IPS.

L PIPE (PVC)



60" x 40"
Female Bottom PIP/IPS
Female Top OD

6" PIP	6-2716	14.9	251.00
8" PIP	6-2717	23.2	349.00
10" PIP	6-2718	32.6	449.00
12" PIP	6-2719	53.5	580.00
6" IPS	6-2720	16.8	295.00
8" IPS	6-2721	25.8	405.00
10" IPS	6-2722	36.7	529.00
12" IPS	6-2723	61.0	710.00

J PIPE PVC



48" x 20"
Female Bottom PIP/IPS
Female Top OD
UPS Shippable

6" PIP	6-2724	10.9	215.00
8" PIP	6-2725	31.0	279.00
10" PIP	6-2726	24.6	380.00
12" PIP	6-2727	39.5	515.00
6" IPS	6-2728	10.9	229.00
8" IPS	6-2729	31.2	315.00
10" IPS	6-2730	24.6	435.00
12" IPS	6-2731	39.5	545.00

*12 gauge(.105" wall) Steel tubing
*11, 10, or 7 gauge also available, please call.

AIR & PRESSURE VALVES

Underground Fittings

Product	Description	Part Number	Weight	List Price
AIR RELIEF VALVE (CAST ALUM)		1.5"	6-1909	1.2 26.50
		2"	6-1910	1.6 29.00
		3"	6-1912	3.1 68.00
		4"	6-1913	6.0 159.00

Venting air in any pressurized pipe is of major importance. Air relief valves help protect the irrigation system from serious head surges and water hammer.

AIR RELIEF VALVE (NYLON)	Guardian	1" 65ARIA100	9-6952	0.2	34.00
		2" 65ARIA2	9-6953	0.3	49.00
		3" 65ARIA3	9-6954	0.7	143.00
Advantages	<ul style="list-style-type: none"> Made of corrosion-resistant reinforced UV protected composite materials. No metal to rust or corrode. 5-year warranty 	Continuous	2" 65ARIB2	9-6951	1.1 245.00

Product	Description	Part Number	Weight	List Price	
					Threads on Bolt
PRESSURE RELIEF VALVE	4" FPT	Cast Alum.	50#	6-1919	5.5 155.00
			80#	9 6-1920	5.5 155.00
			100#	12 6-1921	5.5 155.00
			125#	3 6-1922	6.0 160.00
			160#	6-1923	6.0 160.00

	Cast Alum.	80#	9-6822	6.0	162.00
		Steel Galv.	85#	9-6823	150.00
	Steel Galv.				

TRI-ACTION VALVE (CAST ALUMINUM)		3" 0-50 psi	6-1915	17.0	295.00
		3" 50-160 psi	6-1914	24.0	295.00

- Pressure Relief
- Air Relief
- Vacuum Relief

TRI-ACTION VALVE PARTS				
	Hanger Bolt (3 req.)	1	9-7453	14.00
	Decal	2	9-7454	6.00
	Hanger Washer (3 req.)	3	9-7455	1.00
	Vave Disc Stem	4	9-7456	2.00
	Head Cap	5	9-7457	33.00
	Cap Gasket	6	9-7458	5.50
	Retainer Spring	7	9-7459	3.00
	Valve Disc	8	9-7460	6.00
	Stem Nut (2 req.)	9	9-7461	1.00
	Washer	10	9-7462	1.00
	Valve Body	11	9-7463	145.00
	Gauge Indicator	12	9-7464	7.00
	Compression Spring	13	9-7465	146.00
	Hanger	14	9-7466	57.00
	Hanger Bolt Nut (3 req.)	15	9-7467	1.00

RISER VALVE TEES PIP



Product	Description	Part Number	Weight	List Price
RISER VALVE TEE (POWDER COATED OR GALVANIZED)	6"x6"x4"x30"	6-3921	27.2	191.00
	6"x6"x4"x36"	6-3922	29.5	194.00
	6"x6"x4"x42"	6-3923	31.7	198.00
	6"x6"x4"x54"	6-3924	33.8	213.00
	8"x8"x4"x30"	6-3931	32.3	221.00
	8"x8"x4"x36"	6-3932	34.6	225.00
	8"x8"x4"x42"	6-3933	36.8	230.00
	8"x8"x4"x54"	6-3934	41.3	245.00
	10"x10"x4"x30"	6-3941	39.5	259.00
	10"x10"x4"x36"	6-3942	41.7	264.00
	10"x10"x4"x42"	6-3943	44.0	267.00
	10"x10"x4"x54"	6-3944	48.5	277.00
	12"x12"x4"x30"	6-3951	44.6	292.00
	12"x12"x4"x36"	6-3952	46.9	295.00
	12"x12"x4"x42"	6-3953	49.1	301.00
	12"x12"x4"x54"	6-3954	53.6	319.00
	6"x6"x6"x30"	6-3961	36.0	228.00
	6"x6"x6"x36"	6-3962	39.4	236.00
	6"x6"x6"x42"	6-3963	42.8	244.00
	6"x6"x6"x54"	6-3964	49.6	255.00
	8"x8"x6"x30"	6-3971	41.4	256.00
	8"x8"x6"x36"	6-3972	44.8	263.00
	8"x8"x6"x42"	6-3973	48.2	272.00
	8"x8"x6"x54"	6-3974	55.0	295.00
	10"x10"x6"x30"	6-3981	49.0	287.00
	10"x10"x6"x36"	6-3982	52.4	294.00
	10"x10"x6"x42"	6-3983	55.8	305.00
	10"x10"x6"x54"	6-3984	62.6	339.00
	12"x12"x6"x30"	6-3991	54.5	352.00
	12"x12"x6"x36"	6-3992	57.9	358.00
	12"x12"x6"x42"	6-3993	61.3	366.00
	12"x12"x6"x54"	6-3994	68.1	385.00
	8"x8"x8"x30"	8-1300	58.0	345.00
	8"x8"x8"x36"	8-1301	62.5	349.00
	8"x8"x8"x42"	8-1302	67.0	352.00
8"x8"x8"x54"	8-1303	76.0	360.00	
10"x10"x8"x30"	8-1308	66.3	360.00	
10"x10"x8"x36"	8-1309	70.8	365.00	
10"x10"x8"x42"	8-1310	75.3	370.00	
10"x10"x8"x54"	8-1311	84.3	375.00	
12"x12"x8"x30"	8-1316	72.6	410.00	
12"x12"x8"x36"	8-1317	77.1	430.00	
12"x12"x8"x42"	8-1318	81.6	445.00	
12"x12"x8"x54"	8-1319	90.6	460.00	

Male PIP may be substituted for female at \$10 list / each.

***IMPORTANT:** When ordering, indicate either GALVANIZED or POWDER COATED finishes.

***Custom-Built Fittings will be made to order.** The riser length is measured from the top of the mainline to the top of the valve. Other sizes available on request. Special discounts on quantity orders. Metric Sizes available. Please call for special requests.

Product	Description	Part Number	Weight	List Price
RISER VALVE TEE (POWDER COATED OR GALVANIZED)	4"x4"x4"x30"	6-3915	17.8	180.00
	4"x4"x4"x36"	6-3916	20.1	184.00
	4"x4"x4"x42"	6-3917	22.3	187.00
	4"x4"x4"x54"	6-3918	26.8	198.00
	6"x6"x4"x30"	6-3925	27.2	191.00
	6"x6"x4"x36"	6-3926	29.5	194.00
	6"x6"x4"x42"	6-3927	31.7	198.00
	6"x6"x4"x54"	6-3928	36.2	213.00
	8"x8"x4"x30"	6-3935	32.3	221.00
	8"x8"x4"x36"	6-3936	34.6	225.00
	8"x8"x4"x42"	6-3937	36.8	230.00
	8"x8"x4"x54"	6-3938	41.3	245.00
	10"x10"x4"x30"	6-3945	39.5	259.00
	10"x10"x4"x36"	6-3946	41.7	264.00
	10"x10"x4"x42"	6-3947	44.0	267.00
	10"x10"x4"x54"	6-3948	48.5	277.00
	12"x12"x4"x30"	6-3955	44.6	292.00
	12"x12"x4"x36"	6-3956	46.9	295.00
	12"x12"x4"x42"	6-3957	49.1	301.00
	12"x12"x4"x54"	6-3958	53.6	319.00
	6"x6"x6"x30"	6-3965	36.0	228.00
	6"x6"x6"x36"	6-3966	39.4	236.00
	6"x6"x6"x42"	6-3967	42.8	244.00
	6"x6"x6"x54"	6-3968	49.6	255.00
	8"x8"x6"x30"	6-3975	41.4	256.00
	8"x8"x6"x36"	6-3976	44.8	263.00
	8"x8"x6"x42"	6-3977	48.2	272.00
	8"x8"x6"x54"	6-3978	55.0	295.00
	10"x10"x6"x30"	6-3985	49.0	287.00
	10"x10"x6"x36"	6-3986	52.4	294.00
	10"x10"x6"x42"	6-3987	55.8	305.00
	10"x10"x6"x54"	6-3988	62.6	339.00
	12"x12"x6"x30"	6-3995	54.5	352.00
	12"x12"x6"x36"	6-3996	57.9	358.00
	12"x12"x6"x42"	6-3997	61.3	366.00
	12"x12"x6"x54"	6-3998	68.1	385.00
	8"x8"x8"x30"	8-1304	58.0	345.00
	8"x8"x8"x36"	8-1305	62.5	349.00
	8"x8"x8"x42"	8-1306	67.0	352.00
	8"x8"x8"x54"	8-1307	76.0	360.00
10"x10"x8"x30"	8-1312	66.3	360.00	
10"x10"x8"x36"	8-1313	70.8	365.00	
10"x10"x8"x42"	8-1314	75.3	370.00	
10"x10"x8"x54"	8-1315	84.3	375.00	
12"x12"x8"x30"	8-1320	72.6	410.00	
12"x12"x8"x36"	8-1321	77.1	430.00	
12"x12"x8"x42"	8-1322	81.6	445.00	
12"x12"x8"x54"	8-1323	90.6	460.00	



Male PIP maybe substituted for female at \$10 list / each.

***IMPORTANT:** When ordering, indicate either GALVANIZED or POWDER COATED finishes.

***Custom-Built Fittings will be made to order.** The riser length is measured from the top of the mainline to the top of the valve. Other sizes available on request. Special discounts on quantity orders. Metric Sizes available. Please call for special requests.

REPAIR COUPLERS



Product	Description	Part Number	Weight	List Price
REPAIR COUPLER (PVC)	6" PIP	6-2261	4.0	53.00
	8" PIP	6-2262	6.0	75.00
	10" PIP	6-2263	10.0	120.00
	12" PIP	6-2267	15.0	165.00
	15" PIP	6-2268	20.0	250.00
	6" IPS	6-2264	4.0	45.00
	8" IPS	6-2265	6.0	55.00
	10" IPS	6-2266	10.0	85.00
	12" IPS	6-2269	15.0	110.00



-100 psi maximum pressure.
-19" long

PVC PIPE

(PLAIN X GASKET, 31" LONG, #100)

	6" PIP	6-2294	4.8	60.00
	8" PIP	6-2295	8.4	90.00
	10" PIP	6-2296	13.2	120.00
	12" PIP	6-2297	19.3	150.00
	15" PIP	6-2298	30.1	210.00
	6" IPS	6-2299	5.5	67.00
	8" IPS	6-2300	9.4	110.00
	10" IPS	6-2301	14.6	155.00
12" IPS	6-2302	20.5	230.00	

TELESCOPING REPAIR COUPLER

(PVC)

	6" PIP	6-2610	8.8	113.00
	8" PIP	6-2611	14.4	165.00
	10" PIP	6-2612	23.2	240.00
	12" PIP	6-2613	34.3	315.00
	15" PIP	6-2614	50.1	460.00
	6" IPS	6-2615	9.5	152.00
	8" IPS	6-2616	15.4	163.00
	10" IPS	6-2617	24.6	214.00
12" IPS	6-2618	35.5	340.00	

*Gasket included
*100 psi maximum pressure.

FULL REPAIR WRAP

	OD 4" dia x 8" long	6-9829	11.0	186.00
	IPS 4" dia x 8" long	6-9830	11.0	195.00
	OD/PIP 6" dia x 8" long	6-9831	12.0	229.00
	IPS 6" dia x 8" long	6-9832	12.0	229.00
	OD/PIP 8" dia x 8" long	6-9833	13.0	269.00
	IPS 8" dia x 8" long	6-9834	13.0	269.00
	OD 10" dia x 8" long	6-9835	19.0	269.00
	IPS 10" dia x 8" long	6-9836	19.0	355.00
	OD/PIP 12" dia x 8" long	6-9837	20.0	355.00
	IPS 12" dia x 8" long	6-9838	20.0	400.00

125 max psi
Ideal to stop leaks without cutting pipeline.

FIBERGLASS TAPE

	1/4" Pipe	1" Wide x 30" Long	6-9562	0.2	17.00
	1/2" Pipe	1" Wide x 32" Long	6-9563		28.00
	3/4" Pipe	2" Wide x 30" Long	6-9564	0.2	19.00
	1" Pipe	2" Wide x 60" Long	6-9565	0.2	23.00
	2" - 4" Pipe	3" Wide x 108" Long	6-9566	0.7	25.00
	3" Pipe	8" Wide x 72" Long	6-9567	0.7	55.00
	6" Pipe	4" Wide x 180" Long	6-9568	0.7	39.00
	8" Pipe	4" Wide x 360" Long	6-9569	1.3	75.00

Product
BOLT-ON REPAIR COUPLER
(POWDER COATED)



-180 psi maximum pressure.
-16" long



-16" Long
-Fits OD, PIP, & IPS Flange Packs



2 Flange Packs Required per repair coupler.



REPAIR COUPLER
(POWDER COATED OR GALVANIZED)

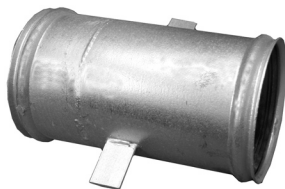

*Metric sizes available, please call.
200 psi maximum pressure on 2" to 10".
150 psi maximum pressure on 12" and 15".
16" long

Description	Part Number	Weight	List Price
Complete 6" PIP	6-2206	21.0	157.00
8" PIP	6-2208	26.0	205.00
10" PIP	6-2210	36.0	268.00
12" PIP	6-2212	44.0	396.00
15" PIP	6-2200	52.0	449.00
18" PIP	6-9888	58.0	970.00
4" IPS	6-2207	12.0	121.00
6" IPS	6-2213	21.0	157.00
8" IPS	6-2214	26.0	205.00
10" IPS	6-2215	36.0	268.00
12" IPS	6-2216	44.0	396.00

Body Only			
4"	6-2033	8.0	75.00
6"	6-2034	13.0	99.00
8"	6-2035	17.0	125.00
10"	6-2036	24.0	152.00
12"	6-2037	29.0	234.00
15"	6-2038	36.0	339.00

Flange Pack (Single)			
6" OD/PIP	6-2011	4.0	29.00
8" OD/PIP	6-2012	4.5	40.00
10" OD/PIP	6-2013	6.0	58.00
12" OD/PIP	6-2014	7.5	81.00
15" PIP	9-5851	8.0	101.00
18.7" PIP	9-5852	18.0	135.00
20.4" PIP	9-5853	22.0	148.00
4" IPS	6-2016	2.0	23.00
6" IPS	6-2017	4.0	29.00
8" IPS	6-2018	4.5	40.00
10" IPS	6-2019	6.0	58.00
12" IPS	6-2020	7.5	81.00

Gasket (Bolt-on)			
6" OD/PIP	9-5837		7.50
8" OD/PIP	9-5839		9.50
10" OD/PIP	9-5829		19.00
12" OD/PIP	9-5831		23.00
15" PIP	9-5832		25.00
18.7" PIP	9-5841		35.00
20.4" PIP	9-5842		36.00
4" IPS	9-5833		5.30
6" IPS	9-5836		7.50
8" IPS	9-5838		9.50
10" IPS	9-5828		19.00
12" IPS	9-5830		23.00

6" PIP	6-2250	13.0	86.00
8" PIP	6-2251	17.0	117.00
10" PIP	6-2252	21.0	145.00
12" PIP	6-2253	24.0	204.00
15" PIP	6-2255	50.0	405.00
4" IPS	6-2239	7.0	82.00
6" IPS	6-2240	13.0	86.00
8" IPS	6-2241	17.0	117.00
10" IPS	6-2242	21.0	145.00
12" IPS	6-2243	24.0	204.00

BOLT-ON SADDLES & RISERS



Product	Description	Part Number	Weight	List Price	
SADDLE RISER 	36"	6"x4" x 36"	6-3820	22.0	152.00
		8"x4" x 36"	6-3821	24.0	159.00
		10"x4" x 36"	6-3822	26.0	167.00
		12"x4" x 36"	6-3823	28.0	187.00
	42"	6"x4" x 42"	6-3825	22.0	171.00
		8"x4" x 42"	6-3826	24.0	225.00
		10"x4" x 42"	6-3827	26.0	200.00
		12"x4" x 42"	6-3828	28.0	210.00

For PIP or IPS use.
Steel powder coated or galvanized.

SADDLE RISER (WITH PVC RISER)

- Lightweight
- Easy to install
- Durable
- Sunlight (UV) Inhibited
- UPS Shippable
- For PIP or IPS use
- Using 3"x36" & 48" SCH80
- Using 3" outlet on galvanized saddle
- Using 3" x4" galvanized valve stubs.

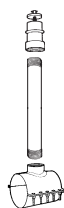

42"	6"x4" x 42"	6-3804	19.0	196.00
	8"x4" x 42"	6-3805	20.0	206.00
	10"x4" x 42"	6-3806	23.0	224.00
	12"x4" x 42"	6-3830	25.0	242.00
54"	6"x4" x 54"	6-3807	21.0	200.00
	8"x4" x 54"	6-3808	22.0	210.00
	10"x4" x 54"	6-3809	20.0	228.00
	12"x4" x 54"	6-3831	27.0	246.00

SADDLE (POWDER COATED OR GALVANIZED)

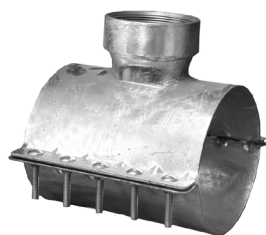

W/FPT				
6" x 3"	6" x 3"	6-3810	11.0	107.00
	8" x 3"	6-3811	12.0	117.00
	10" x 3"	6-3812	15.0	135.00
	12" x 3"	6-3813	17.0	153.00
	15" x 3"	9-7628	23.0	181.00
	18" x 3"	9-7629	28.0	606.00
6" x 4"	6" x 4"	6-3814	12.0	117.00
	8" x 4"	6-3815	13.0	124.00
	10" x 4"	6-3816	16.0	142.00
	12" x 4"	6-3817	18.0	159.00
8" x 6"	8" x 6"	9-7632	20.0	173.00
	10" x 6"	9-7633	22.0	186.00
	12" x 6"	9-7634	24.0	205.00
	15" x 6"	9-7635	26.0	246.00
	18" x 6"	9-7636	31.0	663.00

For PIP or IPS use.

PVC RISER PIPE

- 3" double male threaded
- High density polyethylene riser pipe w/UV inhibitor



3"x36" (for 42" riser)	6-3802	3.0	15.00
4"x36" (for 42" riser)	6-3790		29.00
3"x48" (for 54" riser)	6-3803	5.0	19.00
4"x48" (for 54" riser)	6-3791		39.00

RISER TEE (MPT TOP)

-For use as air relief valve in the line.



8"x8"x2"mpt x54", PIP	9-5319		278.00
-----------------------	--------	--	--------

UNDERGROUND COUPLERS & MALE ENDS

Underground Fittings

Product	Description	Part Number	Weight	List Price
WELD-ON COUPLER (POWDER COATED)		PVC Pipe O.D.		
	6" PIP	6.140"	6-2231	6.0 39.00
	8" PIP	8.160"	6-2232	8.0 50.00
	10" PIP	10.20"	6-2233	11.0 70.00
	12" PIP	12.240"	6-2234	13.0 83.00
	15" PIP	15.30"	6-2235	14.0 179.00
	18" PIP	18.701"	6-2600	19.0 358.00
	2" IPS	2.375"	6-2217	40.00
	2.5" IPS	2.875"	6-2218	40.00
	3" IPS	3.50"	6-2219	2.0 40.00
	4" IPS	4.50"	6-2220	3.0 32.00
	6" IPS	6.63"	6-2221	6.0 39.00
	8" IPS	8.625"	6-2222	8.0 50.00
	10" IPS	10.750"	6-2223	11.0 70.00
	12" IPS	12.750"	6-2224	13.0 83.00
	6" Metric (160mm)	6.30"	6-2226	44.30
	8" Metric(200mm)	7.87"	6-2227	58.00
10" Metric(250mm)	9.84"	6-2228	81.50	
12" Metric(315mm)	12.41"	6-2229	98.00	



WELD-ON COUPLER (STAINLESS STEEL)		PVC Pipe O.D.		
	6" PIP	6.140"	9-5159	3.5 410.00
	8" PIP	8.160"	9-5160	6.5 480.00
	4" IPS	4.50"	9-5156	2.5 330.00
	6" IPS	6.25"	9-5157	3.5 449.00
	8" IPS	8.625"	9-5158	6.5 525.00



#304 Stainless Steel

WELD-ON COUPLER (BLACK)		PVC Pipe O.D.		
	6" PIP	6.140"	9-5043	6.0 36.00
	8" PIP	8.160"	9-5044	8.0 45.00
	10" PIP	10.20"	9-5045	11.0 65.00
	12" PIP	12.240"	9-5046	13.0 80.00
	15" PIP	15.30"	9-7441	-- 155.00
	4" IPS	4.50"	9-5037	3.0 30.00
	6" IPS	6."	9-5038	6.0 36.00
	8" IPS	8.625"	9-5039	8.0 45.00
	10" IPS	10.750"	9-5040	11.0 65.00
12" IPS	12.750"	9-5041	13.0 80.00	



WELD-ON MALE END (POWDER COATED)	6" PIP	6-2281	3.5 53.00
	8" PIP	6-2282	6.5 59.00
	10" PIP	6-2283	10.5 63.00
	12" PIP	6-2284	12.5 74.00
	15" PIP	6-2285	14.0 158.00
	4" IPS	6-2289	2.5 48.00
	6" IPS	6-2290	3.5 53.00
	8" IPS	6-2291	6.5 59.00
	10" IPS	6-2292	10.5 63.00
	12" IPS	6-2293	12.5 74.00



ACCESSORIES FOR PVC



Product	Description	Part Number	Weight	List Price
---------	-------------	-------------	--------	------------

PRIMER

(Step 1 of 2)

Purple
It is highly recommended to apply primer on both pipe & socket before gluing to pre-soften & prepare plastic pipe & fittings for bonding.



1 quart	6-9170	2.0	16.50
---------	--------	-----	-------

PVC GLUE

(Step 2 of 2)

Gray, C-200, PVC 12, Heavy Body for larger diameters.
When primer is still wet, apply heavy amt of glue on pipe & lighter amt. in socket.
Wipe off excess.



1 quart	6-9130	2.0	19.50
1 gallon	6-9140	8.5	59.00

PIPE LUBE

One gallon of pipe lube will cover 50 8" pipe joints.



1 quart	6-9160	2.0	9.00
1 gallon	6-9150	8.5	27.00

AVERAGE NUMBER OF JOINTS/QT. OF WELD-ON CEMENTS

Pipe Diameter	1/2"	3/4"	1"	1 1/2"	2"	3"	4"	6"	8"	10"	12"	15"	18"
Number of Joints	300	200	125	90	60	40	30	10	5	2-3	1-2	3/4	1/2

GASKET

(UNDERGROUND)



ROUNDBACK:

6" PIP	6-4241	0.3	9.50
8" PIP	6-4242	0.6	11.50
10" PIP	6-4243	0.8	16.50
12" PIP	6-4244	1.0	21.50
15" PIP	6-4245		24.00
18" PIP	9-5291		50.00

4" IPS	6-4233		7.00
6" IPS	6-4234	0.3	9.50
8" IPS	6-4235	0.6	11.50
10" IPS	6-4236	0.8	16.50
12" IPS	6-4237	1.0	21.50

SQUAREBACK:

6" PIP	9-7645	1.8	8.00
8" PIP	9-7647	2.0	10.00
10" PIP	9-7638	2.3	19.50
12" PIP	9-7640	2.5	24.00
15" PIP	9-7641		28.00
18" PIP	9-7642		59.00

4" IPS	9-7643	1.3	6.00
6" IPS	9-7644	1.8	8.00
8" IPS	9-7646	2.0	10.00
10" IPS	9-7637	2.3	19.50
12" IPS	9-7639		24.00

DRAW BAND



6"	6-1704	0.6	10.10
8"	6-1705	0.7	10.30
10"	6-1706	0.9	10.70
12" (for 10" Newby boot)	6-1707	1.0	11.00
14"	6-1708	1.1	11.50
15"	6-1709	1.2	13.50

*For #80 PIP plastic pipe, state other psi sizes.

Product	Description	Part Number	Weight	List Price
BOLT-ON COUPLER (POWDER COATED)	COMPLETE			
	6" OD/PIP	6-4015	11.0	100.00
	8" OD/PIP	6-4016	14.0	124.00
	10" OD/PIP	6-4017	18.0	167.00
	12" OD/PIP	6-4018	22.0	211.00
	15" PIP	6-4019	25.0	230.00
	18.7" PIP	6-9787	30.0	310.00
	20.4" PIP	9-5843	35.0	337.00
	4" IPS	6-4010	8.0	67.00
	6" IPS	6-4011	11.0	100.00
	8" IPS	6-4012	14.0	124.00
	10" IPS	6-4013	18.0	167.00
	12" IPS	6-4014	22.0	211.00
	HALF BODY			
	4"	6-2045	6.0	44.00
	5"	6-2046	6.0	52.00
	6"	6-2047	7.0	71.00
	8"	6-2048	9.0	84.00
	10"	6-2049	13.0	109.00
	12"	6-2062	16.0	130.00
15"	9-5848	19.0	161.00	
18.7"	9-5849	22.0	216.00	
20.4"	9-5850	25.0	236.00	
FLANGE PACK (SINGLE)				
4" OD	6-2027	3.0	23.00	
5" OD	6-2028	4.0	40.00	
6" OD/PIP	6-2011	4.0	29.00	
8" OD/PIP	6-2012	4.5	40.00	
10" OD/PIP	6-2013	6.0	58.00	
12" OD/PIP	6-2014	7.5	81.00	
15" PIP	9-5851	8.0	101.00	
18.7" PIP	9-5852	18.0	135.00	
20.4" PIP	9-5853	22.0	148.00	

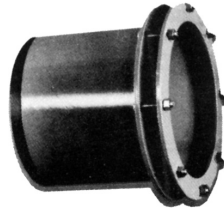

9" long.
Male weld-on x bolt-on coupler

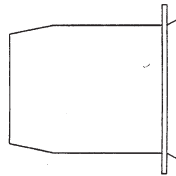

See page 11 for IPS Flange Pack.
Replacement gaskets are on page 11.

BOLT-ON COUPLER (BLACK)	COMPLETE				
	4" OD	Black	9-5019	8.0	57.00
	6" OD/PIP	Black	9-5023	11.0	73.00
	8" OD/PIP	Black	9-5026	14.5	86.00
	10" OD/PIP	Black	9-5029	18.5	105.00
	12" OD/PIP	Black	9-5032	22.0	175.00
	4" IPS	Black	9-5021	8.0	57.00
	6" IPS	Black	9-5024	11.0	73.00
	8" IPS	Black	9-5027	14.5	86.00
	10" IPS	Black	9-5030	18.5	105.00
	12" IPS	Black	9-5033	22.0	175.00



9" long.
Male weld-on x bolt-on

BOLT-ON DRESSER REDUCER (POWDER COATED OR GALVANIZED)	4" IPS x 4" OD	6-4020	13.0	121.00
	6" PIP x 6" OD	6-4021	21.0	157.00
	6" IPS x 6" OD	6-4022	21.0	157.00
	6" IPS x 6" PIP	6-4023	21.0	157.00
	8" IPS x 6" PIP	6-4024	27.5	230.00
	8" IPS x 6" OD	6-4025	27.5	230.00
	8" IPS x 6" IPS	6-4026	27.5	230.00
	8" IPS x 8" OD	6-4027	26.0	205.00
	8" IPS x 8" PIP	6-4028	26.0	205.00
	10" PIP x 8" PIP	6-4029	35.2	285.00
	10" PIP x 8" IPS	6-4031	35.2	285.00
	10" PIP x 10" OD	6-4030	36.0	268.00
	10" IPS x 10" OD	6-4032	36.0	268.00
	10" IPS x 10" PIP	6-4033	36.0	268.00
12" PIP x 10" PIP	6-4034	44.0	395.00	
12" PIP x 12" OD	6-4035	44.0	396.00	
12" IPS x 12" PIP	6-4036	44.0	396.00	

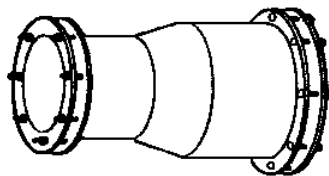

STEEL UNDERGROUND FITTINGS



Product	Description	Part Number	Weight	List Price
FLANGE ADAPTER (POWER COATED <u>OR</u> GALVANIZED)	6" PIP	6-4051	15.3	115.00
	8" PIP	6-4052	20.9	135.00
	10" PIP	6-4053	27.6	165.00
	12" PIP	6-4054	36.0	195.00
	4" IPS	6-4043	10.1	100.00
	6" IPS	6-4045	15.3	115.00
	8" IPS	6-4046	20.9	135.00
	10" IPS	6-4047	27.6	165.00
	12" IPS	6-4048	36.0	195.00



*Metric sizes available, please call.

SERVICE TEE

(POWER COATED OR GALVANIZED)



6"x6"x4" PIP	6-4064	17.4	140.00
8"x8"x3" PIP	9-5311	19.0	144.00
8"x8"x4" PIP	6-4065	27.5	160.00
4"x4"x2" IPS	6-4060	8.7	120.00
6"x6"x4" IPS	6-4061	17.4	140.00
8"x8"x4" IPS	6-4062	22.5	160.00

*Metric sizes available.
Other sizes also available.

Male Nipple available.
Please call.

TEE

(POWER COATED OR GALVANIZED)



6" PIP	6-4079	24.8	169.00
8" PIP	6-4080	33.0	199.00
10" PIP	6-4081	44.3	245.00
12" PIP	6-4082	66.2	320.00
15" PIP	6-4083	76.0	725.00
4" IPS	6-4073	13.5	140.00
6" IPS	6-4074	24.8	169.00
8" IPS	6-4075	33.0	199.00
10" IPS	6-4076	44.3	245.00
12" IPS	6-4077	66.2	320.00

*Metric sizes available.
Reducing Tees also available.
Please call.

CROSS

(POWER COATED OR GALVANIZED)





6" PIP	6-4099	37.6	305.00
8" PIP	6-4100	50.0	315.00
10" PIP	6-4101	66.6	389.00
12" PIP	6-4102	79.2	415.00
15" PIP	6-4103	92.4	910.00
4" IPS	6-4093	21.0	225.00
6" IPS	6-4094	37.6	305.00
8" IPS	6-4095	50.0	315.00
10" IPS	6-4096	66.6	389.00
12" IPS	6-4097	79.2	415.00

*Metric sizes available, please call.
Reducing sizes also available. Please call.

STEEL UNDERGROUND FITTINGS

Product	Description	Part Number	Weight	List Price
REDUCER (POWER COATED <u>OR</u> GALVANIZED)	4" IPS x 6" PIP	6-4110	10.2	119.00
	6" PIP x 8" PIP	6-4111	16.5	139.00
	8" PIP x 10" PIP	6-4112	22.2	166.00
	10" PIP x 12" PIP	6-4113	37.0	225.00
				

ADAPTER (POWER COATED <u>OR</u> GALVANIZED)	6" PIP x IPS	6-4121	12.0	120.00
	8" PIP x IPS	6-4122	16.0	125.00
	10" PIP x IPS	6-4123	22.0	150.00
	12" PIP x IPS	6-4124	26.0	155.00
				

45° ELBOW (POWER COATED <u>OR</u> GALVANIZED)	6" PIP	6-4130	22.2	150.00
	8" PIP	6-4131	29.5	165.00
	10" PIP	6-4132	39.0	219.00
	12" PIP	6-4133	46.4	250.00
	4" IPS	6-4137	12.8	125.00
	6" IPS	6-4138	22.2	150.00
	8" IPS	6-4139	29.5	165.00
	10" IPS	6-4140	39.0	219.00
	12" IPS	6-4141	46.4	250.00
				

11° and 22° are available at the same price.

90° ELBOW (POWER COATED <u>OR</u> GALVANIZED)	6" PIP	6-4150	22.2	165.00
	8" PIP	6-4151	29.5	180.00
	10" PIP	6-4152	39.0	250.00
	12" PIP	6-4153	46.4	290.00
	4" IPS	6-4157	10.5	135.00
	6" IPS	6-4158	22.2	165.00
	8" IPS	6-4159	29.5	180.00
	10" IPS	6-4160	39.0	250.00
	12" IPS	6-4161	46.4	290.00
				

Other sizes are available.
Metric sizes are also available.
Please Call.

STEEL UNDERGROUND FITTINGS



Product	Description	Part Number	Weight	List Price
DOUBLE COUPLER, (POWER COATED <u>OR</u> GALVANIZED)	6" PIP	6-4171	12.0	100.00
	8" PIP	6-4172	16.0	120.00
	10" PIP	6-4173	22.0	150.00
	12" PIP	6-4174	26.0	160.00
	15" PIP	6-4175	28.0	390.00
	4" IPS	6-4179	6.0	95.00
	6" IPS	6-4180	12.0	100.00
	8" IPS	6-4181	16.0	120.00
	10" IPS	6-4182	22.0	150.00
	12" IPS	6-4183	26.0	160.00



*Metric sizes available, please call.

END PLUG, (POWER COATED OR GALVANIZED)

6" PIP	6-4191	4.5	80.00
8" PIP	6-4192	9.8	90.00
10" PIP	6-4193	14.5	105.00
12" PIP	6-4188	18.3	120.00
15" PIP	6-4189	14.0	260.00
4" IPS	6-4197	2.9	75.00
6" IPS	6-4198	4.5	80.00
8" IPS	6-4199	9.8	90.00
10" IPS	6-4200	14.5	105.00
12" IPS	6-4201	18.3	120.00



END CAP, (POWER COATED OR GALVANIZED)

6" PIP	6-4203	7.0	75.00
8" PIP	6-4204	11.3	85.00
10" PIP	6-4205	15.0	115.00
12" PIP	6-4206	18.8	139.00
15" PIP	6-4207	14.0	315.00
4" IPS	6-4211	3.4	65.00
6" IPS	6-4212	7.0	75.00
8" IPS	6-4213	11.3	85.00
10" IPS	6-4214	15.0	115.00
12" IPS	6-4215	18.8	139.00



*Metric sizes available, please call.

SOLVENT PVC PIPE FITTINGS

Underground Fittings

Product	Description	Part Number	Weight	List Price
90° ELBOW (PVC-SOLVENT)	6" PIP	6-2311	4.0	65.00
	8" PIP	6-2312	6.0	117.00
	10" PIP	6-2313	8.0	165.00
	12" PIP	6-2314	14.0	231.00
	15" PIP	6-2320	20.0	358.00
	6" IPS	6-2560	4.0	54.00
	8" IPS	6-2561	6.0	82.00
	10" IPS	6-2562	8.0	128.00
	12" IPS	6-2563	14.0	178.00
	4" IPS A&H	6-2315	2.0	14.00
	6" PIP A&H	6-2316	1.5	40.00
	8" PIP A&H	6-2317	2.5	48.00
	10" PIP A&H	6-2318	3.0	75.00
	12" PIP A&H	6-2319	3.5	114.00

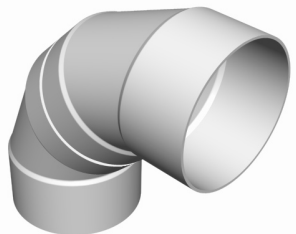

#100 psi test, except A&H which is #22/#50 psi test.

*Metric sizes available, please call.

45° ELBOW (PVC-SOLVENT)	6" PIP	6-2321	1.0	28.00
	8" PIP	6-2322	2.0	48.00
	10" PIP	6-2323	2.5	72.00
	12" PIP	6-2324	3.0	107.00
	15" PIP	6-2330	4.0	167.00
	6" IPS	6-2550	1.0	28.00
	8" IPS	6-2551	2.0	46.00
	10" IPS	6-2552	2.5	70.00
	12" IPS	6-2553	3.0	102.00
	4" IPS A&H	6-2325	1.3	18.00
	6" PIP A&H	6-2326	1.5	24.00
	8" PIP A&H	6-2327	1.8	30.00
	10" PIP A&H	6-2328	2.0	37.00
	12" PIP A&H	6-2329	3.0	57.00

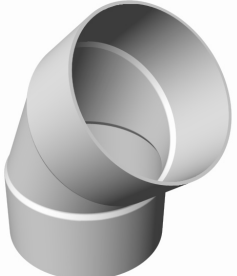

#100 psi test, except A&H which is #22/#50 psi test.

*Metric sizes available, please call.

22.5° ELBOW (PVC-SOLVENT)	6" PIP	6-2270	1.0	21.00
	8" PIP	6-2271	2.0	31.00
	10" PIP	6-2272	2.5	58.00
	12" PIP	6-2273	3.0	81.00
	15" PIP	6-2274	4.0	136.00

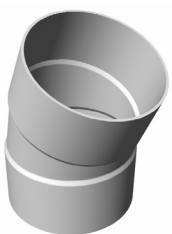

#100 psi test.

*Metric sizes available, please call.

**11°, 15°, 30° AND 60° ELBOWS AVAILABLE UPON REQUEST.
PLEASE CALL.**

SOLVENT PVC PIPE FITTINGS

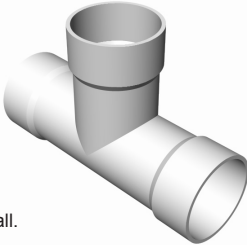

Product	Description	Part Number	Weight	List Price	
TEE (PVC-SOLVENT)					
		6" PIP	6-2331	5.0	56.00
		8" PIP	6-2332	9.0	83.00
		10" PIP	6-2333	14.0	132.00
		12" PIP	6-2334	18.0	211.00
		15" PIP	6-2336	25.0	362.00
		4" IPS	6-2335	2.3	30.00
		6" IPS	6-2570	5.0	76.00
		8" IPS	6-2571	9.0	96.00
		10" IPS	6-2572	14.0	134.00
		12" IPS	6-2573	18.0	210.00

#100 psi test

*Metric sizes available, please call.

REDUCING TEE

(PVC-SOLVENT)



6" x 4" PIP	6-2340	3.5	42.00
8" x 4" PIP	6-2341	4.5	55.00
8" x 6" PIP	6-2342	8.5	68.00
6" x 4" IPS	6-2574	4.0	49.00
8" x 4" IPS	6-2575	5.0	66.00
8" x 6" IPS	6-2576	9.0	85.00

#100 psi test

*Metric sizes available, please call.

WYE

(PVC-SOLVENT)

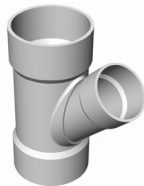

6" PIP A&H	6-2601		40.00
8" PIP A&H	6-2602		85.00
10" PIP A&H	6-2603		125.00

Drain Only

END CAP

(PVC-SOLVENT)

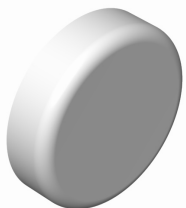

6" PIP	6-2410	1.5	26.00
8" PIP	6-2411	2.0	33.00
10" PIP	6-2412	2.5	53.00
12" PIP	6-2413	3.0	69.00
15" PIP	6-2414	4.0	113.00
6" IPS	6-2580	1.5	23.00
8" IPS	6-2581	2.0	30.00
10" IPS	6-2582	2.5	47.00
12" IPS	6-2583	3.0	90.00
6" PIP A&H	6-2420	0.2	7.00
8" PIP A&H	6-2421	0.6	11.00
10" PIP A&H	6-2422	2.5	18.00
12" PIP A&H	6-2423	3.0	28.00
15" PIP A&H	6-2424	4.0	49.00

#100 psi test, except A&H which is #22/#50 psi test.

*Metric sizes available, please call.

COUPLING

(PVC-SOLVENT)

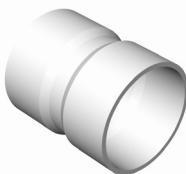

6" PIP	6-2431	1.0	18.00
8" PIP	6-2432	2.0	24.00
10" PIP	6-2433	5.0	38.00
12" PIP	6-2428	7.0	58.00
15" PIP	6-2429	10.0	100.00
4" IPS	6-2430	0.5	9.50
6" IPS	6-2585	1.0	14.00
8" IPS	6-2586	2.0	25.00
10" IPS	6-2587	5.0	40.00
12" IPS	6-2588	7.0	63.00
4" IPS A&H	6-2434	0.4	9.00
6" PIP A&H	6-2435	0.8	12.00
8" PIP A&H	6-2436	1.5	12.00
10" PIP A&H	6-2437	3.0	16.00

#100 psi test, except A&H which is #22/#50 psi test.

*Metric sizes available, please call.

SOLVENT PVC PIPE FITTINGS

Underground Fittings

Product	Description	Part Number	Weight	List Price
REDUCER (PVC-SOLVENT)	6" PIP x 4" IPS	6-2440	1.5	22.00
	8" x 6" PIP	6-2441	2.0	33.00
	10" x 8" PIP	6-2442	3.0	45.00
	12" x 10" PIP	6-2438	4.0	65.00
	15" x 12" PIP	6-2439	5.0	104.00
	6" x 4" IPS	6-2590	1.5	18.00
	8" x 6" IPS	6-2591	2.0	28.00
	10" x 8" IPS	6-2592	3.0	56.00
	12" x 10" IPS	6-2593	4.0	76.00
	6" PIP x 4" IPS A&H	6-2443	0.6	15.00
	8" x 6" PIP A&H	6-2444	1.5	18.00
	10" x 8" PIP A&H	6-2445	2.0	28.00
	12" x 10" PIP A&H	6-2446	2.5	40.00

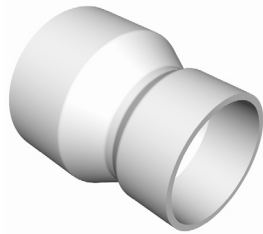

#100 psi test,
Except A&H which is #22/#50 psi test.
*Metric sizes available, please call.

ADAPTER (PVC-SOLVENT)	6" IPS x PIP	6-2451	1.5	21.00
	8" IPS x PIP	6-2452	2.5	30.00
	10" IPS x PIP	6-2453	5.0	50.00



#100 psi test

FLANGE (PVC-SOLVENT)	6" PIP	6-2480	5.6	67.50
	8" PIP	6-2481	8.3	102.50
	10" PIP	6-2482	14.3	143.50
	12" PIP	6-2483	21.9	218.50
	3" IPS	9-7659		32.00
	4" IPS	6-2484	2.8	37.00
	6" IPS	6-2485	4.7	57.50
	8" IPS	6-2486	6.8	92.50
	10" IPS	6-2487	11.6	129.50
	12" IPS	6-2488		141.50



FEMALE THREADED ADAPTER (PVC-SOLVENT)	6" PIP	6-2461		60.00
	8" PIP	6-2462		85.00
	10" PIP	6-2463		120.00
	12" PIP	6-2464		140.00
	4" IPS	6-2470		12.00
	6" IPS	6-2471		41.00
	8" IPS	6-2472		79.00
	10" IPS	6-2473		110.00
	12" IPS	6-2474		150.00



#100 psi test, except
A&H which is #22/#50 psi

MALE THREADED ADAPTER (PVC-SOLVENT)	6" PIP	6-2466		55.00
	8" PIP	6-2467		75.00
	10" PIP	6-2468		110.00
	12" PIP	6-2469		130.00
	4" IPS	6-2475		11.00
	6" IPS	6-2476		28.00
	8" IPS	6-2477		76.00
	10" IPS	6-2478		85.00
	12" IPS	6-2479		125.00

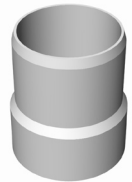

#100 psi test, except A&
which is #22/#50 psi

BUSHING (PVC-SOLVENT)	6" PIP x IPS	6-2595		22.00
	8" PIP x IPS	6-2596		27.00
	10" PIP x IPS	6-2597		41.00
	12" PIP x IPS	6-2598		63.00



IPS outside x PIP inside

GASKETED PVC PIPE FITTINGS

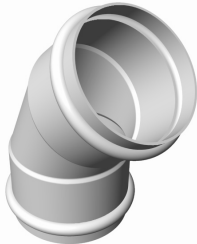
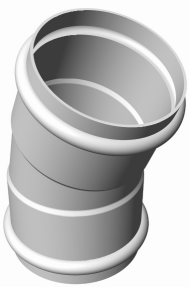
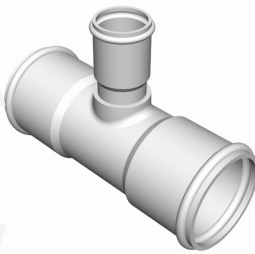

Product	Description	Part Number	Weight	List Price
90° ELBOW (PVC-GASKETED)  #100 PSI Test	6" PIP	6-2350		83.00
	8" PIP	6-2351		133.00
	10" PIP	6-2352		205.00
	12" PIP	6-2353		291.00
	15" PIP	6-2354		594.00
	6" IPS	6-2520		108.00
	8" IPS	6-2521		164.00
	10" IPS	6-2522		238.00
	12" IPS	6-2523		319.00
	45° ELBOW (PVC-GASKETED)  #100 PSI Test	6" PIP	6-2360	
8" PIP		6-2361		104.00
10" PIP		6-2362		150.00
12" PIP		6-2363		213.00
15" PIP		6-2364		430.00
6" IPS		6-2510		74.00
8" IPS		6-2511		104.00
10" IPS		6-2512		150.00
12" IPS		6-2513		226.00
22.5° ELBOW (PVC-GASKETED)  #100 PSI Test		6" PIP	6-2355	
	8" PIP	6-2356		93.00
	10" PIP	6-2357		137.00
	12" PIP	6-2358		198.00
	15" PIP	6-2359		327.00
	6" IPS	6-2500		71.00
	8" IPS	6-2501		86.00
	10" IPS	6-2502		148.00
	12" IPS	6-2503		197.00
	TEE (PVC-GASKETED)  #100 PSI Test	6" PIP	6-2365	
8" PIP		6-2366		132.00
10" PIP		6-2367		201.00
12" PIP		6-2368		273.00
15" PIP		6-2369		493.00
6" IPS		6-2540		85.00
8" IPS		6-2541		151.00
10" IPS		6-2542		219.00
12" IPS		6-2543		304.00

**11°, 15°, 30° AND 60° ELBOWS AVAILABLE UPON REQUEST.
 #100 PSI TEST, EXCEPT A&H WHICH IS #22/#50 PSI TEST.**

Product	Description	Part Number	Weight	List Price
DRAINAGE RISER (PVC-SOLVENT)	4" x 6"	6-2110	16.4	245.00
	6" x 8"	6-2120	24.1	349.00
	8" x 10"	6-2130	43.1	439.00
	Perforated Body Only			
	6" x 7'4"	6-2110-C	12.1	137.00
	8" x 7'4"	6-2120-C	17.3	179.00
	10" x 7'4"	6-2130-C	31.3	225.00
	12" x 6'4"	9-6958	48.2	315.00



6", 8", 10" = 7'4" Long
12" = 6'4" Long

The Drainage Riser comes fully assembled and includes the appropriately sized:
 - 90° elbow
 - increaser
 - cap

The Drainage Riser is made to fit PIP (Plastic Irrigation Pipe).

The Drainage Riser is made to local Soil Conservation Office Specifications.

Other sizes are available on request.

Underground Fittings

RODENT DOOR



4"	6-2181	0.2	9.00
6"	6-2182	0.6	10.00
8"	6-2183	0.8	12.50
10"	6-2184	1.5	17.00
12"	6-2185	2.3	27.00

Always Open...
SchumacherIrrigation.com
 Your Irrigation Superstore