

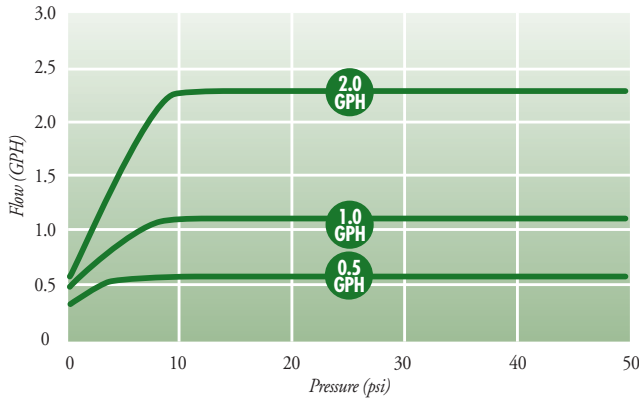

Pressure Compensating Drippers

On-Line Pressure Compensating Dripper

WPC/PC Flow Rate vs. Pressure



PCJ/WPCJ Flow Rate vs. Pressure

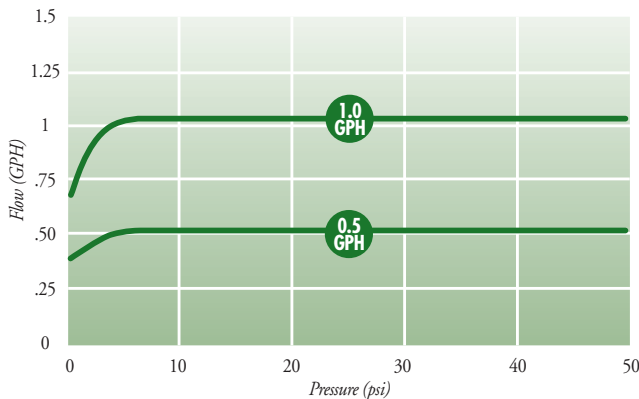

Product Advantages

- Unique pressure differential mechanism provides clog resistant design and high emission uniformity.
- Pressure compensating drippers provide uniform flow distribution, even in areas with difficult topographical conditions.
- **Widest Compensating Range**
 - Maintains uniform flow rate from 7 to 45 psi (maximum normal system operating pressure).
 - Largest flow path in the industry — less susceptible to plugging.
- **Flushing On Demand**
 - Flushes even while irrigating, promoting reliable performance and longer irrigation system life.
- Pressure compensating non-draining mechanism eliminates refill and drainage effects (special CNL mechanism prevents draining up to 15 feet of head - available in most flows).
- **PC Jr. only** - pre-installed drippers reduce installation and labor costs.
 - Factory installation of drippers assures equal spacing of drippers.



Pressure Compensating (PC)
Pressure Compensating



Woodpecker (WPC)
Pressure Compensating with snout



Woodpecker (WPCJ)
Pressure Compensating Junior



PCJ
Pressure Compensating Junior

Applications

- Vine, tree, greenhouse and nursery.
- PCJ only - pre-installed dripper applications.

Specifications

Color: Black

Nominal flow rates (GPH):

- PCJ: .4, .5
- PC, WPC, WPCJ: .5, 1.0, 2.0

Recommended filtration: 120-140 mesh

PART NUMBERS – OUTLET FITS PE TUBING

15016022	WPC Fits .160"/.220" Tubing
15PVC53	WPCJ Fits .125"/.197" Tubing
15FPE53	WPCJ Fits .125"/.197" Tubing



NETAFIM USA

5470 E. Home Ave. • Fresno, CA 93727
 888.638.2346 • 559.453.6800
 FAX 800.695.4753
www.netafimusa.com

Pressure Compensating Drillers Specifications

PC and WPC DRIPPER FLOW PATH DIMENSIONS

Dripper Flow	PC Part #	WPC Part #	Length	Depth	Width
0.5 GPH	01PC2	01WPC2	2.40"	.042"	.046"
1.0 GPH	01PC4	01WPC4	2.36"	.051"	.055"
2.0 GPH	01PC8	01WPC8	0.67"	.063"	.063"

(PC) PRESSURE COMPENSATING DRIPPERS PACKAGING DATA

Dripper Flow	Qty. per Case	Weight (lbs.)	Part Number	Qty. per Bag	Weight (lbs.)	Part Number
0.5 GPH	2,500	42	01PC2	250	4.2	01PC2-B
1.0 GPH	2,500	42	01PC4	250	4.2	01PC4-B
2.0 GPH	2,500	42	01PC8	250	4.2	01PC8-B

(WPC) WOODPECKER PRESSURE COMPENSATING DRIPPERS PACKAGING DATA

Dripper Flow	Qty. per Case	Weight (lbs.)	Part Number	Qty. per Bag	Weight (lbs.)	Part Number
0.5 GPH	2,500	42.3	01WPC2	250	4.2	01WPC2-B
1.0 GPH	2,500	42.3	01WPC4	250	4.2	01WPC4-B
2.0 GPH	2,500	42.3	01WPC8	250	4.2	01WPC8-B

WPCJ and PCJ DRIPPER FLOW PATH DIMENSIONS (0.4 GPH not shown)

Dripper Flow	WPCJ Part #	PCJ Part #	Length	Depth	Width
0.5 GPH	01WPCJL2	01PCJ1	.984"	.033"	.040"
1.0 GPH	01WPCJL4	01PCJ2	.984"	.041"	.047"
2.0 GPH	01WPCJL8	N/A	.984"	.045"	.074"

(WPCJ) WOODPECKER PRESSURE COMPENSATING JUNIOR (WPCJ) DRIPPERS PACKAGING DATA

Dripper Flow	Qty. per Case	Weight (lbs.)	Part Number	Qty. per Bag	Weight (lbs.)	Part Number
0.5 GPH	13,000	31	01WPCJL2	250	1	01WPCJL2-B
1.0 GPH	13,000	31	01WPCJL4	250	1	01WPCJL4-B
2.0 GPH	13,000	31	01WPCJL8	250	1	01WPCJL8-B

(PCJ) PRESSURE COMPENSATING JUNIOR DRIPPERS PACKAGING DATA

Dripper Flow	Qty. per Case	Weight (lbs.)	Part Number	Qty. per Bag	Weight (lbs.)	Part Number
0.4 GPH	14,000	34	01PCJ1.5	250	4.2	01PCJ1.5-B
0.5 GPH	14,000	34	01PCJ2	250	4.2	01PCJ2-B

Pressure Compensating Accessories



Plastic Hole Punch
for installing drippers in
PE Tubing - 0.125", 3mm

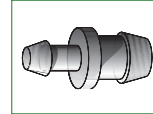

Dual Goof Plug
3mm/17mm



Vineline
Fits 0.670" (17mm) or
0.780" (18mm)
Fits 0.790" (20mm) Tubing

ACCESSORIES PART NUMBERS

682901033	Plastic Hole Punch
1107737-B	Dual Goof Plug
H670780R	.670" VineLine (17mm) or .780" (18mm)
H790R	.790" VineLine (20mm)

Netafim USA - Delivering Total Growing Solutions

- Dripperlines • Filters • Valves • Air Vents • Sprinklers • Automation • Flow Meters
- For Agriculture, Landscape, Greenhouse & Nursery



For more information call Netafim USA
Customer Service at (888) 638-2346.